

GIUBO COUPLING

DIMENSÕES BASICAS EM mm
Mechanical Designer: P.Neto & F.Projeto

generated drawings by the author.

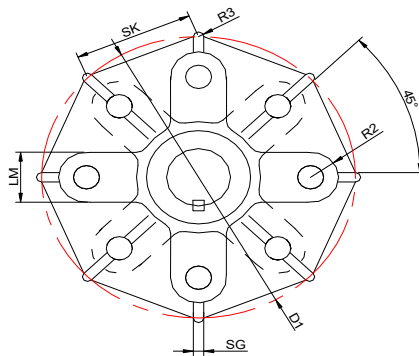
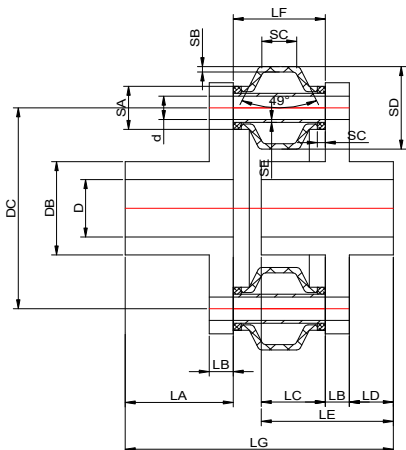
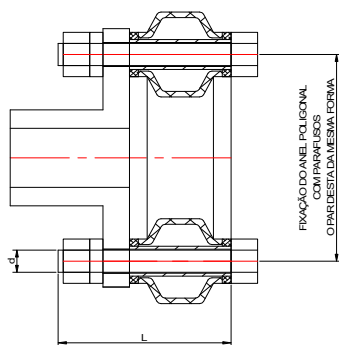

	d	L
PRISION	36	254

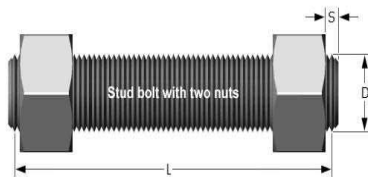

Studs are measured parallel to the axis (L) from the first to the thread without the chamfers (points).

	d	L
PARAF	36	218
	PREFERENCIAL	

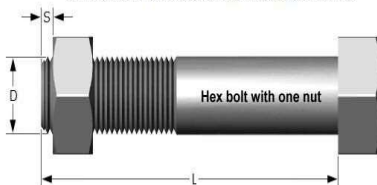

Hex bolts are measured from under the head to the tip of the bolt.



C

DIMENSÕES CALCULADAS



LA	154	GIUBO COUPLING USO Quando se necessita de um acoplamento bastante flexivel e com generosos ajustes radiais e angulares usado para maquinas pesadas ou agricolas.	
LB	34		
LC	91		
LD	63		
LE	188		
LG	381		
LF	131		
LM	79,9		
.SA	68		
.SB	9		
.SC	50		
.SD	131		
.SE	5		
SK	171		
SG	14,9		
D1	447		
R2	39,9		
R3	7,4		
N	4		em cada banda
D	91		eixo
DB	148,3		
DC	319,4		
d	36	OK	
cv	100,00	potencia cv	
n	100	RPM	
S	1,25	fator de segurança	
TORQUE	71620,0	kgcm	
TORQUE	89525,00	kgcm c/ FS	

DADOS BASICOS PARA QUALQUER TIPO DE MATERIAL - PARAFUSOS , ACOPLAMENTO E EIXO

60	tensão admissivel de torque do material usado - Mpa	600	kg/cm2	60000	Pa
75,90466	tensão admissivel de cilhamento do material dos parafusos - kg/cm2				

DIAMETRO DO PARAFUSO COM A TENSÃO ADMISSIVEL

23	d calculado em mm	PARAFUSOS CALCULADOS ATENDEM A SOLICITAÇÃO DO TORQUE NO ACOPLAMENTO
----	-------------------	--